

**502000**

**BREVETTATO**



Curva 90° femmina filettata femmina con flangia.



## Specifiche tecniche

B - UNI EN 10226/1 - Rp

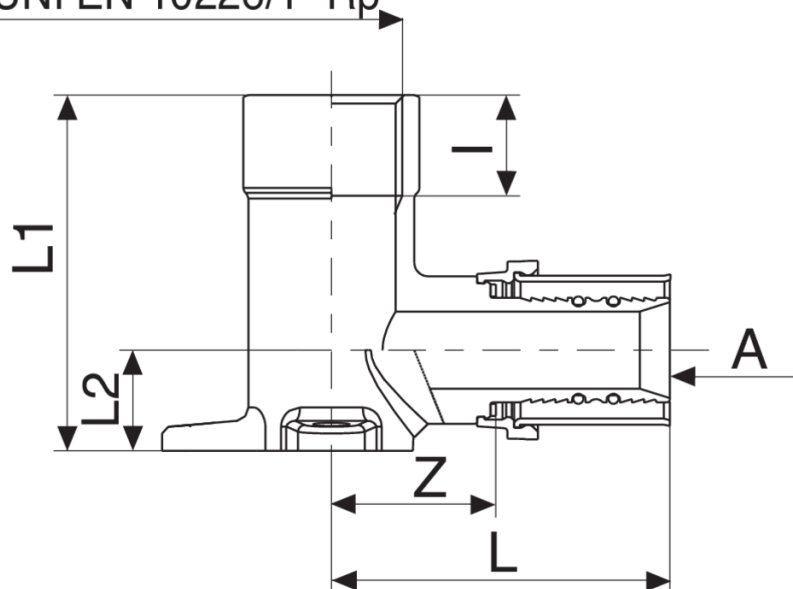

A X B	SP	BAG	BOX	MASTER BOX	CODICE	I	L	L1	L2	Z
14 x 1/2"	2	5	20	80	5020001404	15	50	53	15	24,5
16 x 1/2"	2	5	20	80	5020001604	15	50	53	15	24,5
16 x 1/2"	2	5	30	120	502000160440	15	50	40	16	24,5
18 x 1/2"	2	5	20	80	5020001804	15	50	53	15	24,5
20 x 1/2"	2	5	20	80	5020002004	15	50	53	15	24,5
20 x 1/2"	2	5	20	80	502000200440	15	50	40	16	24,5
26 x 3/4"	3	5	10	40	5020002605	16	52	53	19	20,5

## Applicazioni



DRINKING  
WATER



HEATING



HVAC



COMPRESSED  
AIR



INDUSTRIAL



MARINE