

9595

Raccordo portagomma per gas liquido, filettatura femmina, nichelato.

Specifiche tecniche

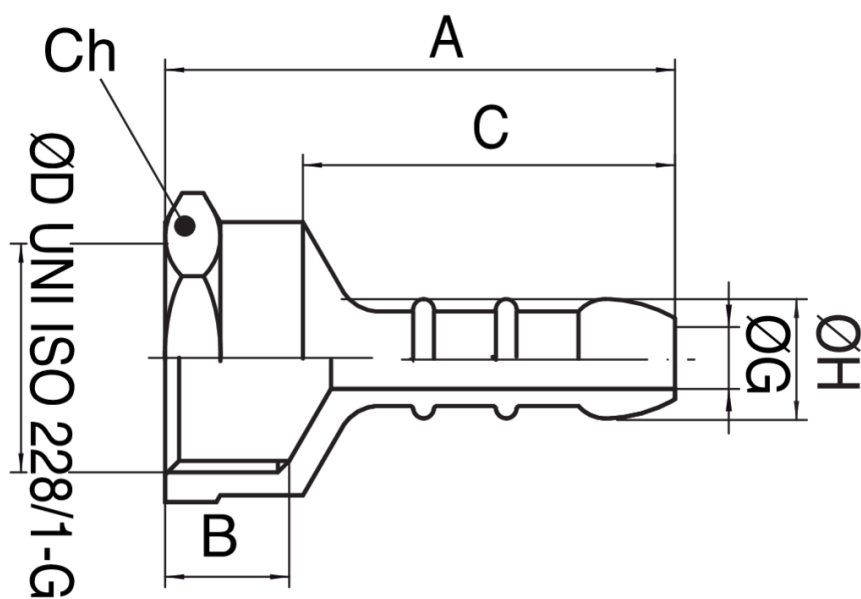

MISURA	BOX	MASTER BOX	CODICE	A	B	C	ØG	ØH	CH
3/8"	50	400	9595030000	37	9	27	4,5	9	21
1/2"	50	400	9595040000	37,5	10	27	4,5	9	25

Applicazioni



DRINKING
WATER



GAS

