

**504200**

**PATENTED**

Étrier et raccords terminales.



## Spécifications techniques

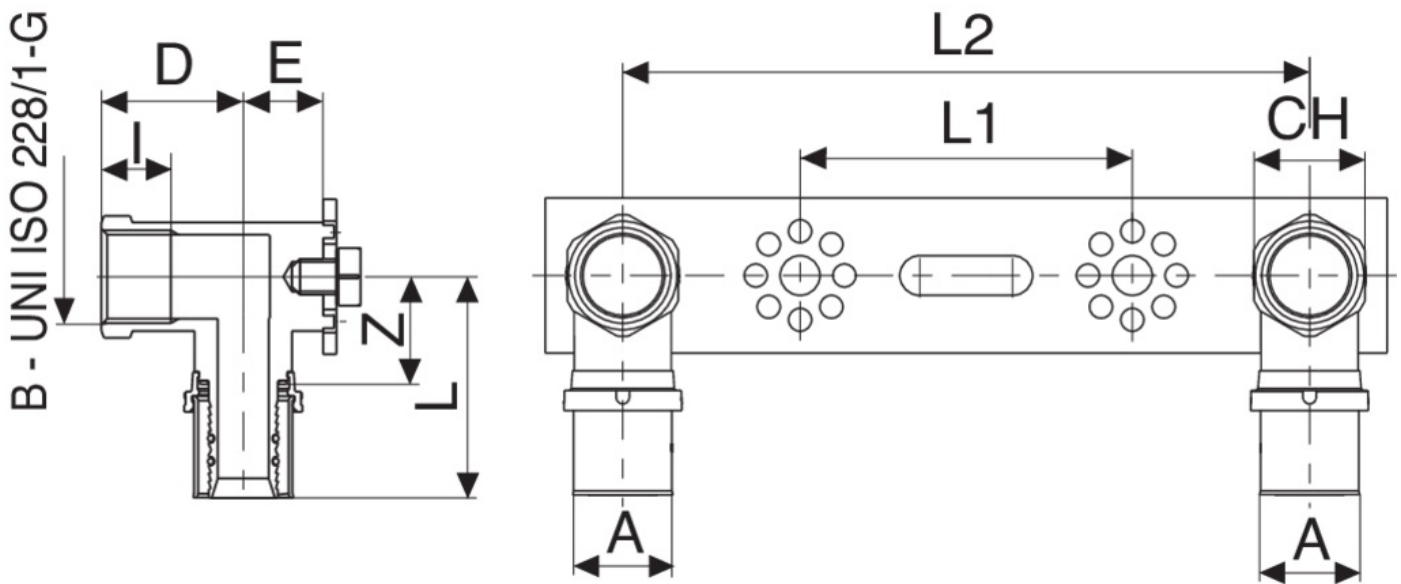

A X B	SP	BAG	BOX	MASTER BOX	CODE	I	CH	D	E	L	L1	L2	Z
16 x 1/2"	2	1	4	16	5042001604	12	25	32	18	50	75	155	24,5
18 x 1/2"	2	1	4	16	5042001804	12	25	32	18	50	75	155	24,5
20 x 1/2"	2	1	4	16	5042002004	12	25	32	18	50	75	155	24,5

## Applications



DRINKING  
WATER



HEATING



HVAC



COMPRESSED  
AIR



INDUSTRIAL



MARINE

