

## RB3280

Manchon filetage mâle/mâle.

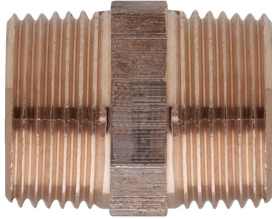

### Spécifications techniques

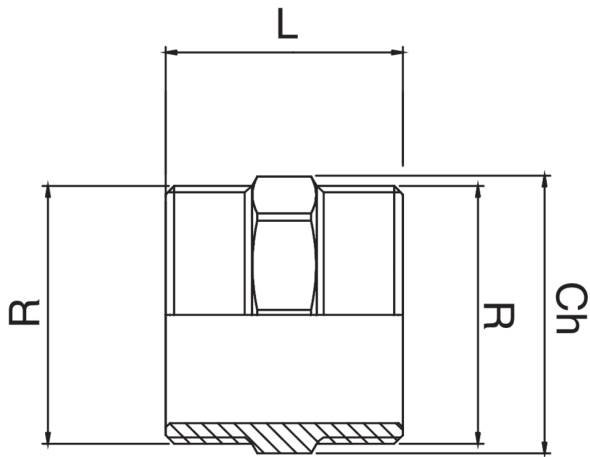

R	BAG	MASTER BOX	CODE	CH	L
1/4"	10	250	RB3280A14A14000	17	25
3/8"	10	500	RB3280A38A38000	17	26
1/2"	10	250	RB3280A12A12000	21	30
3/4"	10	100	RB3280A34A34000	27	33
1"	10	100	RB3280B01B01000	34	40
1 1/4"	5	50	RB3280B14B14000	42	45
1 1/2"	5	40	RB3280B12B12000	48	47
2"	5	25	RB3280C02C02000	60	55
2 1/2"	1	8	RB3280C12C12000	90	65
3"	1	15	RB3280D03D03000	95	75

### Applications

