

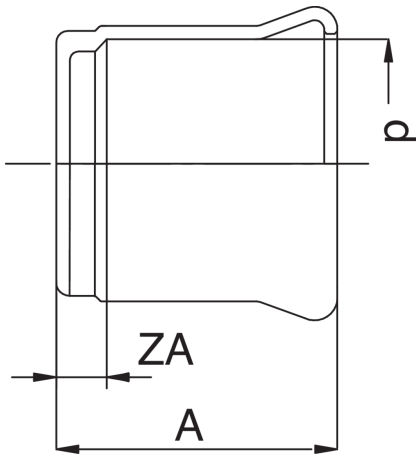

Tapón H de cobre.



## Especificaciones técnicas



| D    | BAG | MASTER BOX | CÓDIGO          | A  | ZA |
|------|-----|------------|-----------------|----|----|
| 66,7 | 1   | 30         | RR9301067000000 | 52 | 5  |
| 76,1 | 1   | 15         | RR9301076000000 | 60 | 5  |
| 88,9 | 1   | 10         | RR9301089000000 | 65 | 5  |
| 108  | 1   | 4          | RR9301108000000 | 75 | 5  |

## Aplicaciones



DRINKING  
WATER



HEATING



HVAC



COMPRESSED  
AIR



FIREFIGHTING