

R 261

Tapòn macho conico.

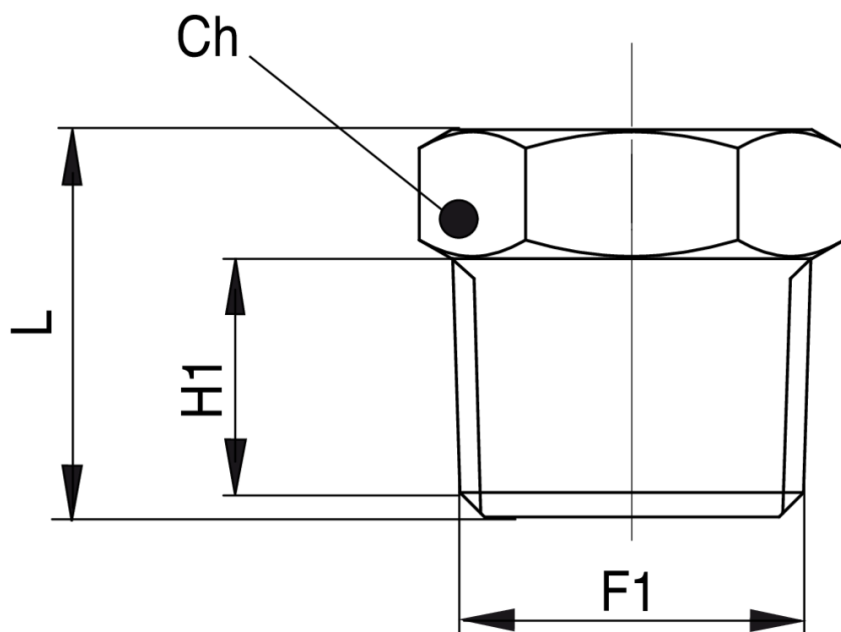

Especificaciones técnicas



| TAMAÑO | BOX | MASTER BOX | CÓDIGO | H1 | CH | L |
|--------|------|------------|----------|----|----|----|
| 1/8 | 1000 | 6000 | R 261 18 | 9 | 11 | 13 |
| 1/4 | 1000 | 2000 | R 261 14 | 10 | 14 | 15 |
| 3/8 | 500 | 1000 | R 261 38 | 12 | 17 | 18 |
| 1/2 | 300 | 600 | R 261 12 | 13 | 23 | 20 |

Aplicaciones



DRINKING
WATER



GAS