

## OT5341

Unión recta rosca macho/hembra + junta.

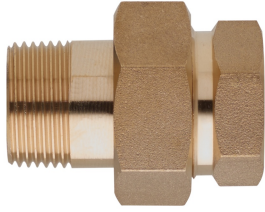

### Especificaciones técnicas

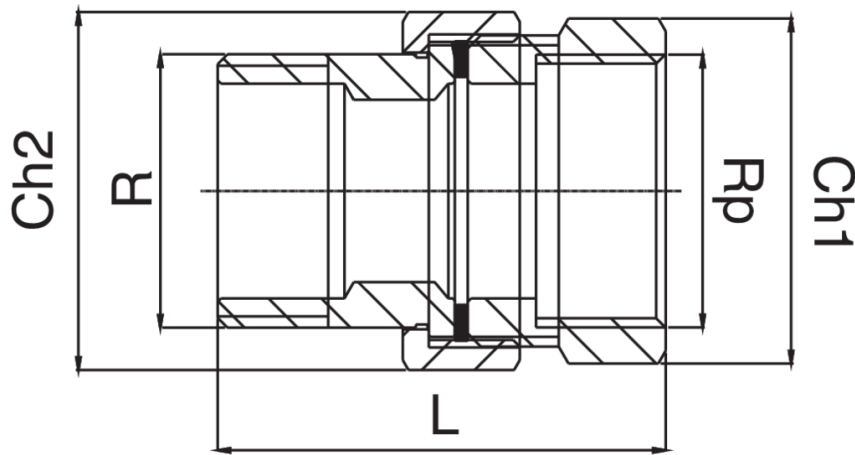

RP X R	BAG	MASTER BOX	CÓDIGO	CH1	CH2	L
3/8" x 3/8"	10	100	OT5341A38A38000	24	27	44
1/2" x 1/2"	10	100	OT5341A12A12000	27	30	47,5
3/4" x 3/4"	5	50	OT5341A34A34000	34	37	53,5
1" x 1"	5	50	OT5341B01B01000	42	46	61,5
1 1/4" x 1 1/4"	5	20	OT5341B14B14000	50	52	69,5
1 1/2" x 1 1/2"	1	15	OT5341B12B12000	56	64	88
2" x 2"	1	8	OT5341C02C02000	70	82	96

### Aplicaciones



DRINKING  
WATER



HEATING



HVAC



GAS



COMPRESSED  
AIR



SOLAR



FIREFIGHTING