

R 146

Recto hembra.

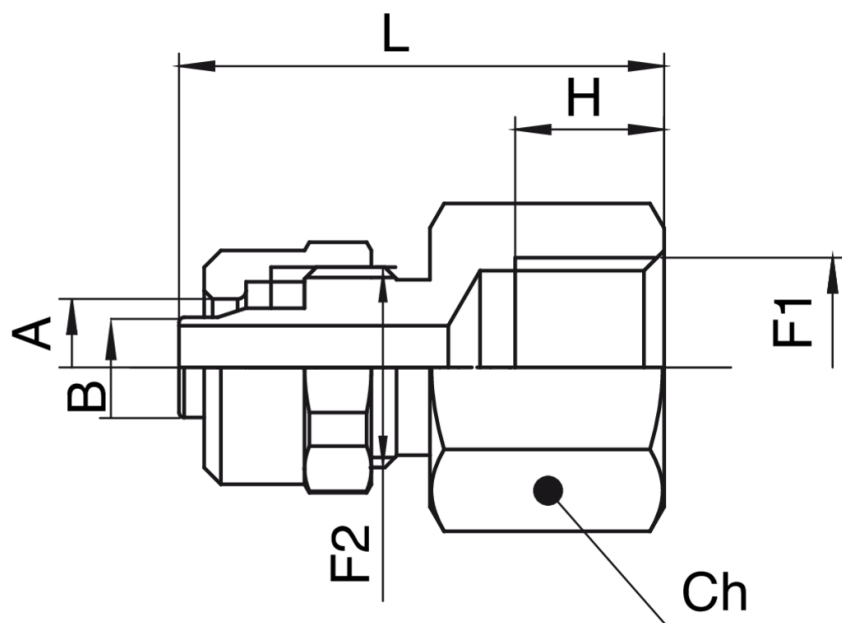

Especificaciones técnicas



F1 X A/B	BOX	MASTER BOX	CÓDIGO	F2	H	CH	L
1/8 x 6/4	500	1000	R 146 18 64	10 x 1	8	14	25
1/8 x 8/6	100	600	R 146 18 86	12 x 1	8	14	25
1/8 x 10/8	300	1200	R 146 18 108	14 x 1	8	14	26,5
1/4 x 6/4	200	800	R 146 14 64	10 x 1	11	17	29
1/4 x 8/6	200	800	R 146 14 86	12 x 1	11	17	29
1/4 x 10/8	180	720	R 146 14 108	14 x 1	11	17	30,5
3/8 x 8/6	145	580	R 146 38 86	12 x 1	11,5	22	29,5

Aplicaciones



DRINKING
WATER



GAS