



Curva 30° macho/hembra.

NEW



Especificaciones técnicas

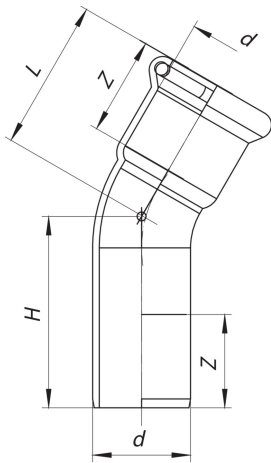

| D | BAG | MASTER BOX | CÓDIGO | L | H | Z |
|------|-----|------------|-----------------|-------|-------|----|
| 76,1 | 1 | 6 | AX0046076076000 | 88,5 | 96,5 | 54 |
| 88,9 | 1 | 3 | AX0046089089000 | 101,5 | 109,5 | 61 |
| 108 | 1 | 2 | AX0046108108000 | 131,4 | 139,4 | 76 |

Aplicaciones



DRINKING
WATER



HEATING



HVAC



COMPRESSED
AIR



FIREFIGHTING



MARINE



STEAM



SOLAR



INDUSTRIAL