

9595

Fitting with hose tail for liquid gas, female threaded, nickel plated.

Technical specifications

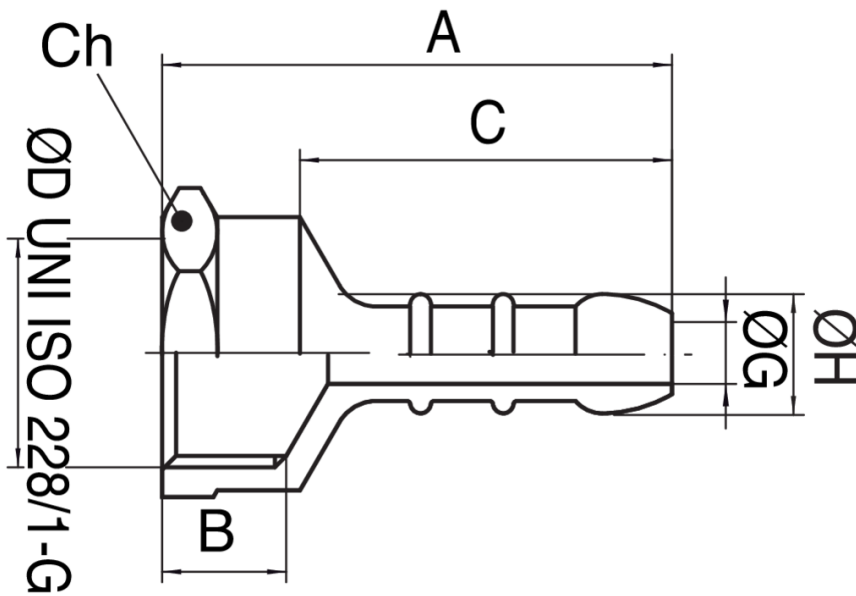

SIZE	BOX	MASTER BOX	CODE	A	B	C	ØG	ØH	CH
3/8"	50	400	9595030000	37	9	27	4,5	9	21
1/2"	50	400	9595040000	37,5	10	27	4,5	9	25

Applications



DRINKING
WATER



GAS

