

**9592**

Fitting with hose tail, female threaded, nickel plated.

## Technical specifications

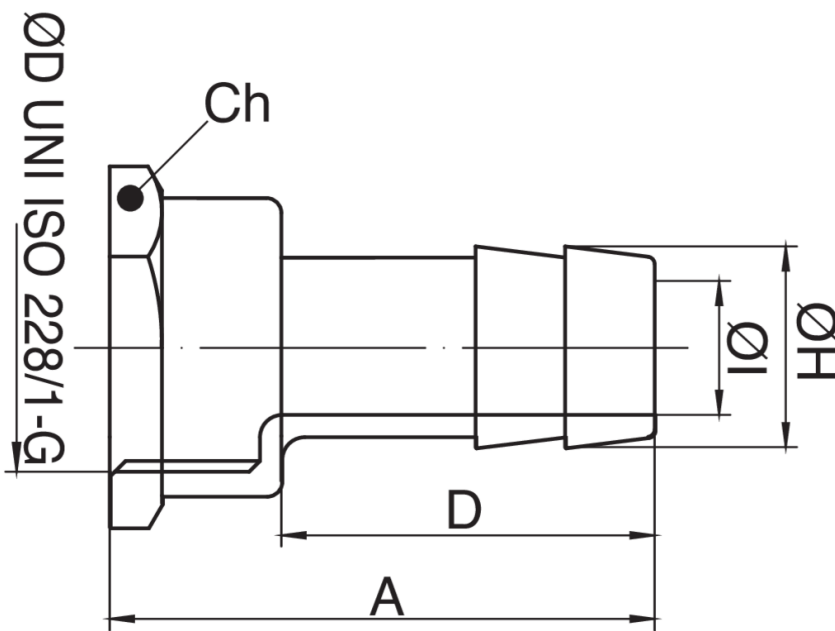

SIZE	BOX	MASTER BOX	CODE	A	D	ØH	ØI	CH
1/8"	50	400	9592010000	28,5	20	9,5	6	13
1/4"	50	400	9592020000	32,5	22	12	8	16
3/8"	50	400	9592030000	35,5	24	13,5	9	21
1/2"	50	400	9592040000	39,5	27	15,5	11	25

## Applications



DRINKING  
WATER



GAS

