

FR5270

F/F coupling.

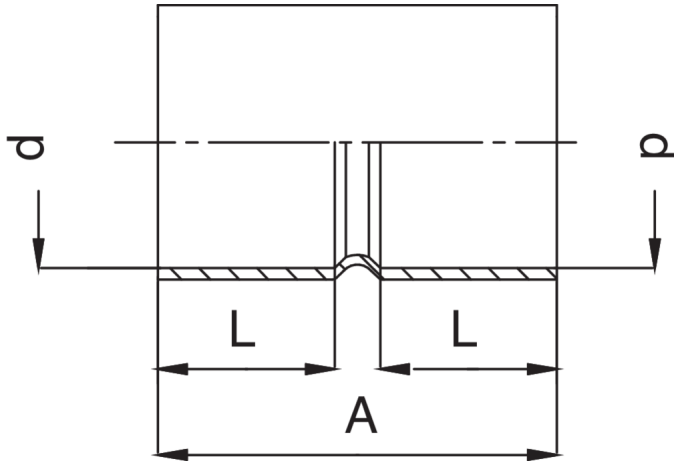

Technical specifications



| D | BAG | MASTER BOX | CODE | A | L MIN |
|--------|-----|------------|-----------------|------|-------|
| 1/4" | 10 | 1000 | FR5270A14A14000 | 14,5 | 6,4 |
| 3/8" | 10 | 150 | FR5270A38A38000 | 17 | 7,9 |
| 1/2" | 10 | 400 | FR5270A12A12000 | 20 | 9,7 |
| 5/8" | 10 | 200 | FR5270A58A58000 | 27 | 12,7 |
| 3/4" | 10 | 180 | FR5270A34A34000 | 33 | 15,8 |
| 7/8" | 10 | 150 | FR5270A78A78000 | 39 | 19,1 |
| 1" | 5 | 100 | FR5270B01B01000 | 45,5 | 22 |
| 1 1/8" | 5 | 80 | FR5270B18B18000 | 47 | 23,1 |
| 1 1/4" | 5 | 50 | FR5270B14B14000 | 44,5 | 21 |
| 1 3/8" | 5 | 50 | FR5270B38B38000 | 51 | 24,6 |
| 1 5/8" | 5 | 30 | FR5270B58B58000 | 57 | 27,7 |
| 2 1/8" | 5 | 15 | FR5270C18C18000 | 70 | 34 |
| 2 5/8" | 1 | 20 | FR5270C58C58000 | 79,5 | 37,5 |
| 3 1/8" | 1 | 20 | FR5270D18D18000 | 103 | 48,5 |

Applications



REFRIGERATION