

500200

PATENTED

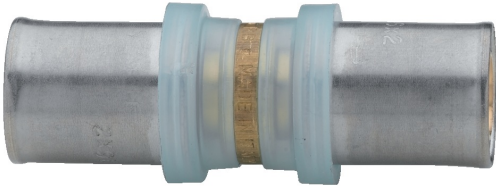

Muffe.



Technische Spezifikationen

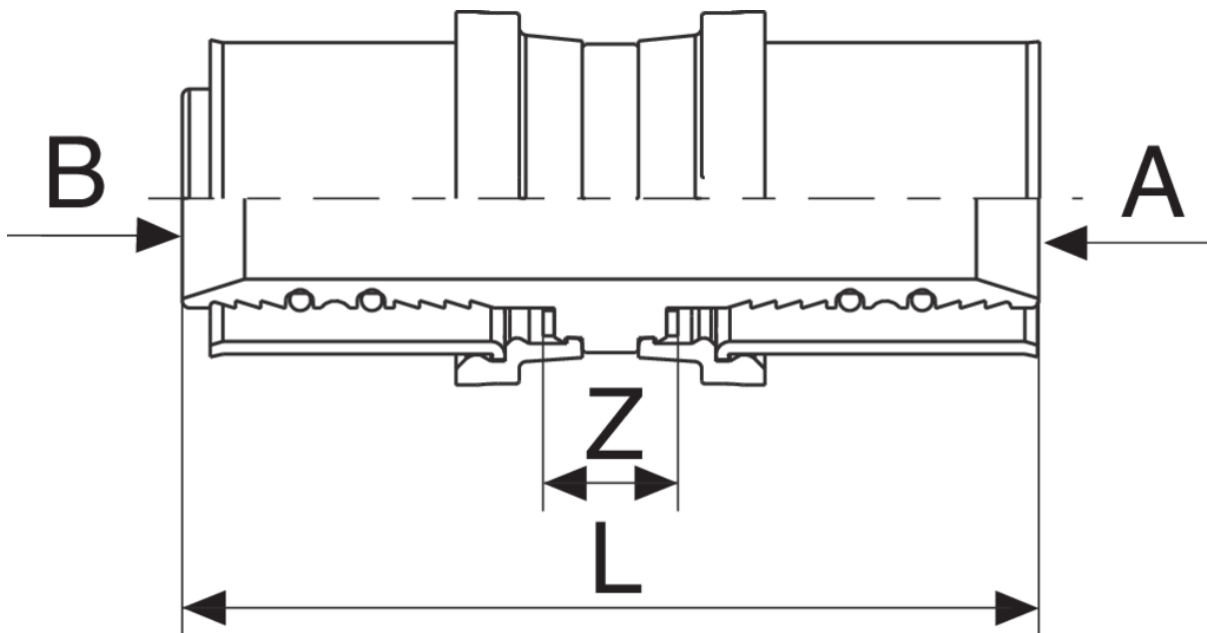

A x B	SP	BAG	BOX	MASTER BOX	CODE	L	Z
14 x 14	2	5	70	280	50020014	60	9
16 x 16	2	5	70	280	50020016	60	9
18 x 18	2	5	50	200	50020018	60	9
20 x 20	2	5	50	200	50020020	61	10
26 x 26	3	5	25	100	50020026	73	11
32 x 32	3	5	20	80	50020032	76	11
40 x 40	3,5	1	10	40	50020040	63	12
50 x 50	4	1	8	32	50020050	80	12
63 x 63	4,5	1	4	16	50020063	80	12

Anwendungen



DRINKING WATER



HEATING



HVAC



COMPRESSED AIR



INDUSTRIAL



MARINE