

RB3341

Rohrverschraubung AxI Gewinde konischdichtend.

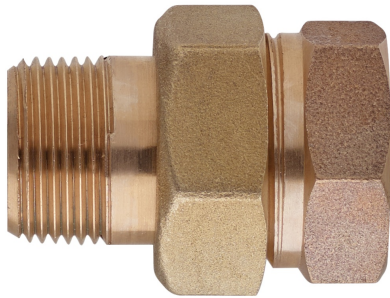

Technische Spezifikationen

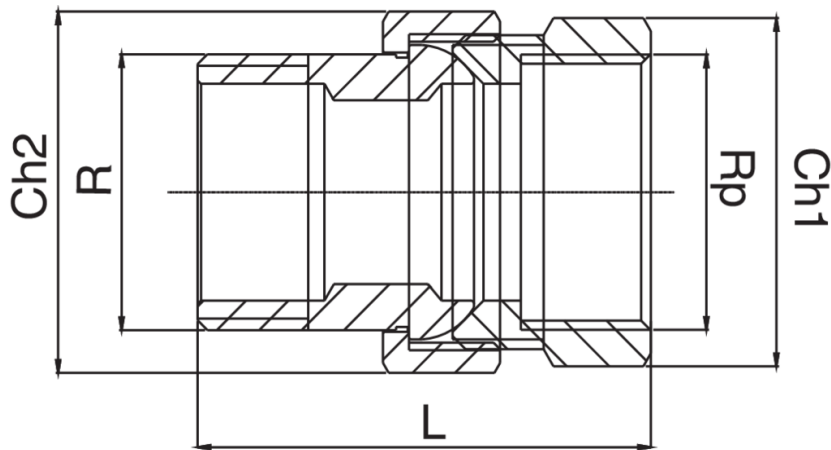

RP/R	BAG	MASTER BOX	CODE	CH1	CH2	L
3/8"	10	100	RB3341A38A38000	24	27	43
1/2"	10	100	RB3341A12A12000	27	30	46
3/4"	5	50	RB3341A34A34000	34	37	53,5
1"	5	30	RB3341B01B01000	42	46	61
1*1/4	5	25	RB3341B14B14000	50	52	70
1*1/2	1	15	RB3341B12B12000	56	64	88
2"	1	10	RB3341C02C02000	70	82	97

Anwendungen



DRINKING
WATER



HEATING



HVAC



GAS



COMPRESSED
AIR



SOLAR



FIREFIGHTING