

R 263

Stopfen.

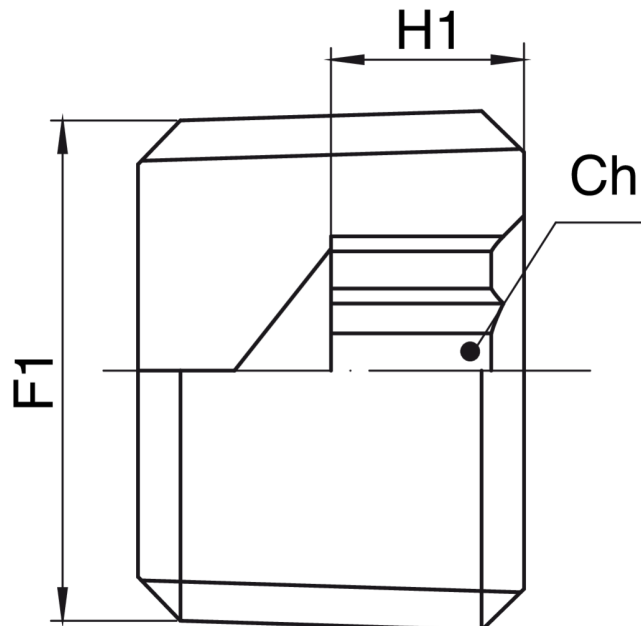

Technische Spezifikationen



| GRÖSSE | BOX | MASTER BOX | CODE | H1 | CH | L |
|--------|------|------------|----------|----|----|----|
| 1/8 | 1500 | 9000 | R 263 18 | 4 | 5 | 8 |
| 1/4 | 300 | 1800 | R 263 14 | 5 | 6 | 10 |
| 1/2 | 200 | 1200 | R 263 12 | 8 | 10 | 12 |

Anwendungen



DRINKING
WATER



GAS