

R 151 Z

Kupplung mit Aussengewinde zylindrisch.

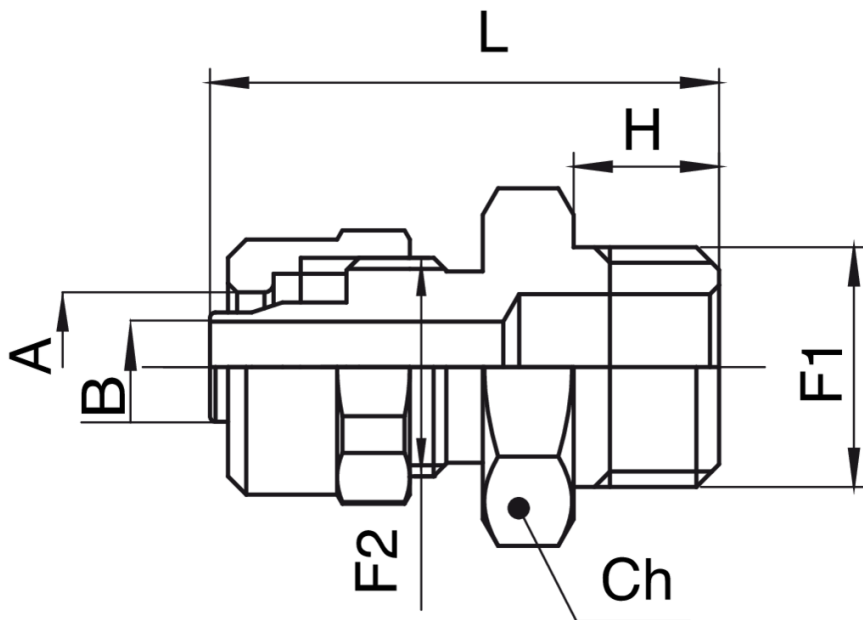

Technische Spezifikationen



| F1 X A/B | BOX | MASTER BOX | CODE | F2 | H | CH | L |
|-------------|------|------------|------------------|----------|---|----|------|
| M5 x 5/3 | 1000 | 6000 | R 151 Z 5M 53 | 7 x 0.75 | 4 | 8 | 20 |
| M5 x 6/4 | 1000 | 6000 | R 151 Z 5M 64 | 8 x 0.75 | 4 | 8 | 21 |
| M6 x 6/4 | 500 | 3000 | R 151 Z 6M 64 | 8 x 0.75 | 5 | 8 | 22 |
| 1/8 x 6/4 | 300 | 1800 | R 151 Z 18 64 | 10 x 1 | 6 | 14 | 25,5 |
| 1/8 x 8/6 | 320 | 1280 | R 151 Z 18 86 | 12 x 1 | 6 | 14 | 25,5 |
| 1/8 x 10/8 | 300 | 1200 | R 151 Z 18 108 | 14 x 1 | 6 | 14 | 27 |
| 1/4 x 6/4 | 250 | 1000 | R 151 Z 14 64 | 10 x 1 | 8 | 17 | 28 |
| 1/4 x 8/6 | 250 | 1000 | R 151 Z 14 86 | 12 x 1 | 8 | 17 | 28 |
| 1/4 x 10/8 | 100 | 400 | R 151 Z 14 108 | 14 x 1 | 8 | 17 | 29,5 |
| 3/8 x 8/6 | 200 | 800 | R 151 Z 38 86 | 12 x 1 | 9 | 19 | 29 |
| 3/8 x 10/8 | 185 | 740 | R 151 Z 38 108 | 14 x 1 | 9 | 19 | 30,5 |
| 3/8 x 12/10 | 150 | 600 | R 151 Z 38 12 10 | 16 x 1 | 9 | 19 | 32 |

Anwendungen



DRINKING
WATER



GAS