

OT6130

T-Stück I mit I Gewinde.

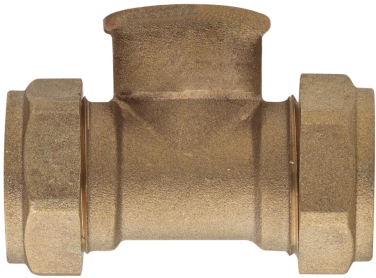

Technische Spezifikationen

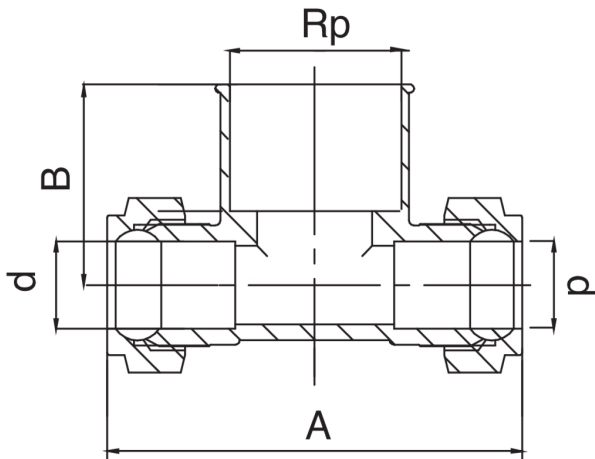

| D X RP | BAG | MASTER BOX | CODE | A | B |
|-----------|-----|------------|-----------------|----|----|
| 10 x 3/8" | 10 | 100 | OT6130010A38010 | 53 | 23 |
| 12 x 1/2" | 10 | 100 | OT6130012A12012 | 57 | 24 |
| 14 x 1/2" | 10 | 100 | OT6130014A12014 | 58 | 26 |
| 15 x 1/2" | 10 | 100 | OT6130015A12015 | 59 | 26 |
| 16 x 1/2" | 10 | 100 | OT6130016A12016 | 59 | 26 |
| 22 x 1/2" | 10 | 100 | OT6130022A12022 | 62 | 27 |

Anwendungen

