

Übergangsstück I mit I Gewinde aus Rotguss.

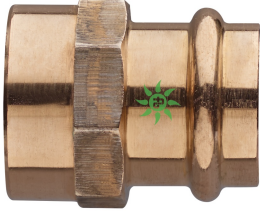

## Technische Spezifikationen

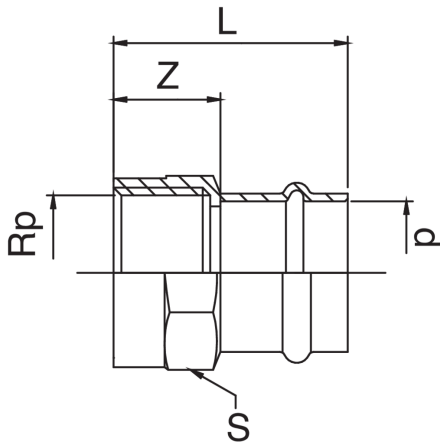

| D X RP    | BAG | MASTER BOX | CODE            | L  | S  | Z |
|-----------|-----|------------|-----------------|----|----|---|
| 15 x 1/2" | 10  | 200        | HT8270A12015000 | 40 | 25 | 3 |
| 18 x 1/2" | 10  | 150        | HT8270A12018000 | 41 | 27 | 3 |
| 18 x 3/4" | 10  | 100        | HT8270A34018000 | 44 | 31 | 4 |
| 22 x 3/4" | 10  | 100        | HT8270A34022000 | 46 | 32 | 5 |
| 22 x 1"   | 5   | 80         | HT8270B01022000 | 47 | 38 | 4 |
| 28 x 3/4" | 5   | 60         | HT8270A34028000 | 48 | 38 | 8 |

## Anwendungen



SOLAR



STEAM



COMPRESSED  
AIR



INDUSTRIAL