



Winkelstück 30° I/A.

**NEW**



## Technische Spezifikationen

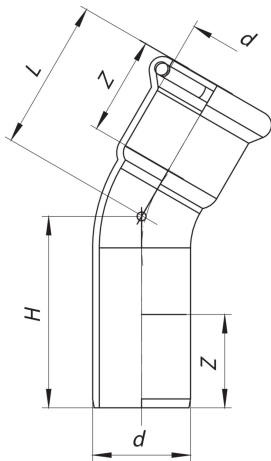

| D  | BAG | MASTER BOX | CODE            | L    | H    | Z    |
|----|-----|------------|-----------------|------|------|------|
| 15 | 10  | 250        | MX0046015015000 | 32,5 | 39   | 19   |
| 18 | 10  | 250        | MX0046018018000 | 29,5 | 36   | 19,5 |
| 22 | 5   | 120        | MX0046022022000 | 34   | 41   | 21   |
| 28 | 5   | 60         | MX0046028028000 | 36   | 42   | 22   |
| 35 | 5   | 40         | MX0046035035000 | 61,3 | 67,8 | 27   |
| 42 | 2   | 28         | MX0046042042000 | 75,8 | 80,1 | 30   |
| 54 | 2   | 16         | MX0046054054000 | 90,5 | 97   | 35   |

## Anwendungen



DRINKING  
WATER



HEATING



HVAC



COMPRESSED  
AIR



FIREFIGHTING



MARINE



STEAM



SOLAR



INDUSTRIAL