

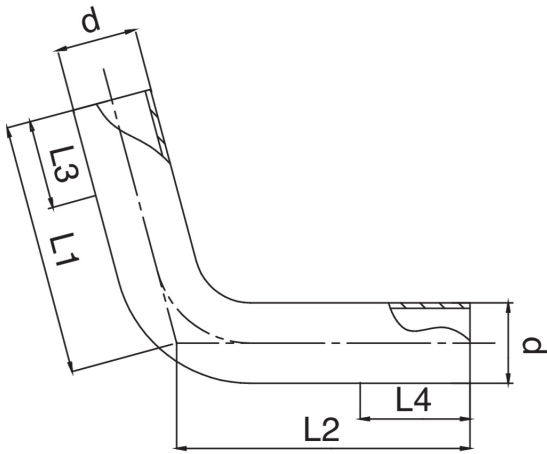

Gebogene Rohrstücke A/A 75°.

## Technische Spezifikationen



| D  | BAG | MASTER BOX | CODE            | L1  | L2  | L3 MIN | L4 MIN |
|----|-----|------------|-----------------|-----|-----|--------|--------|
| 15 | 5   | 30         | ZX0075015015000 | 66  | 117 | 25     | 25     |
| 18 | 5   | 30         | ZX0075018018000 | 65  | 120 | 25     | 25     |
| 22 | 5   | 30         | ZX0075022022000 | 64  | 118 | 30     | 30     |
| 28 | 5   | 20         | ZX0075028028000 | 71  | 114 | 30     | 30     |
| 35 | 5   | 15         | ZX0075035035000 | 110 | 200 | 30     | 30     |
| 42 | 2   | 10         | ZX0075042042000 | 137 | 251 | 45     | 45     |
| 54 | 2   | 10         | ZX0075054054000 | 178 | 305 | 65     | 65     |

## Anwendungen

